

8400Series SS/CS/CC 1/4"-2"

- All ASTM Grade Materials
- Standard Port Design
- Low Operating Torque
- Chevron Style Stem Packing
- Locking Oval or Lever Handle Available
- Full Depth N.P.T. Threads
- Standard Actuator Mounting Pads
- Designed per MSS SP 110

Specifications: MSS SP110

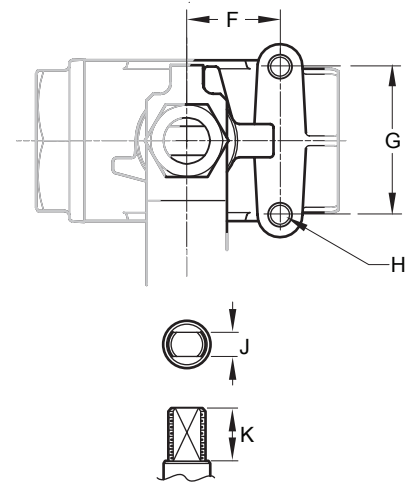
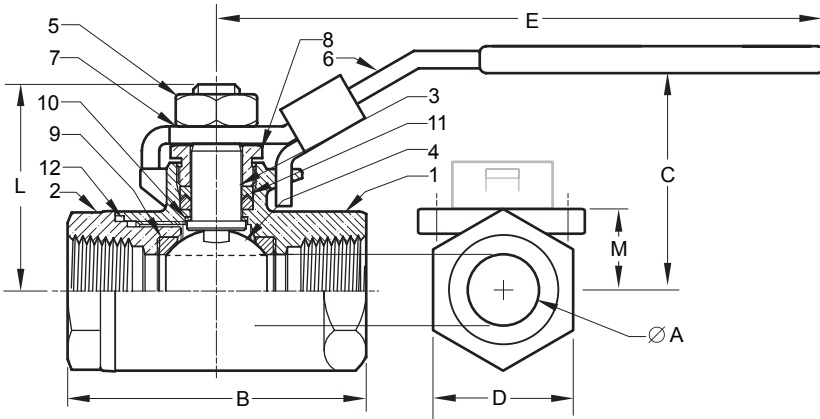
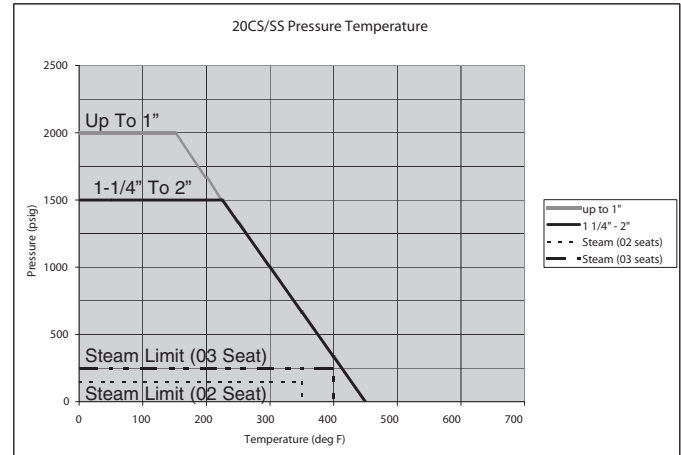

Item	Part Name	8433	8423	8422
1	Body	Stainless Steel ASTM A351/A744 CF8M	Carbon Steel ASTM A216 WCB	Carbon Steel ASTM A216 WCB
2	Tailpiece			
3	Stem	Stainless Steel ASTM A276 Type 316		Carbon Steel AISI 11L41
4	Ball			
5	Handle Nut	Stainless Steel Type 18-8		Carbon Steel AISI 1022
6	Handle	Stainless Steel Type 304		
7	Lock Washer			
8	Packing Nut	Stainless Steel ASTM A276 Type 316	Carbon Steel AISI 12L14	Carbon Steel AISI 11L14
9	Seat	NXT - 75 PTFE		
10	Thrust Washer			
11	Packing Nut	PTFE		
12	Body Seal			

TORQUE RATINGS and FLOW CO-EFFICIENT

VALVE SIZE	RECOMMENDED ACTUATOR TORQUE at MAXIMUM VALVE PRESSURE in. lbs. (Nm)	Cv
1/4 & 3/8	20	6.8
	2.26	
1/2	40	9.8
	4.52	
3/4	50	25
	5.65	
1	100	35
	11.30	
1-1/4	140	47
	15.82	
1-1/2	190	81
	21.47	
2	240	105
	27.12	

DIMENSIONS

NPS		A	B	C	D	E	F	G	H	J	K	L	M
1/4	IN.	0.38	2.09	1.65	.82	4.19	.50	1.12	10-24NC	.196	.390	0.88	.410
	mm	9.5	53.1	41.9	20.8	106.3	12.7	28.4		5.0	9.9	22.2	10.4
3/8	IN.	0.38	2.09	1.65	.82	4.19	.50	1.12	10-24NC	.196	.390	0.88	.410
	mm	9.5	53.1	41.9	20.8	106.3	12.7	28.4		5.0	9.9	22.2	10.4
1/2	IN.	0.50	2.36	1.77	1.06	4.19	.50	1.12	10-24NC	.196	.390	1.00	0.570
	mm	12.7	59.9	45.0	26.9	106.3	12.7	28.4		5.0	9.9	25.4	14.5
3/4	IN.	0.69	2.80	2.05	1.34	5.75	.87	1.37	10-24NC	.275	.560	1.25	.750
	mm	17.4	71.1	52.1	34.0	146.1	22.1	34.8		7.0	14.2	31.8	19.1
1	IN.	0.88	3.23	2.24	1.62	5.75	.87	1.37	10-24NC	.275	.560	1.25	0.910
	mm	22.2	82.0	56.9	41.1	146.1	22.1	34.8		7.0	14.2	31.8	23.1
1-1/4	IN.	1.00	3.62	2.48	1.88	7.63	.93	1.50	1/4-20NC	.355	.650	1.38	1.050
	mm	25.4	91.9	63.0	47.8	193.7	23.6	38.1		9.0	16.5	34.9	26.7
1-1/2	IN.	1.25	4.06	2.68	2.25	7.63	.93	1.50	1/4-20NC	.355	.650	1.38	1.250
	mm	31.8	103.1	68.1	57.2	193.7	23.6	38.1		9.0	16.5	34.9	31.8
2	IN.	1.50	4.65	2.91	2.75	7.63	.93	1.50	1/4-20NC	.355	.650	1.38	1.520
	mm	38.1	118.1	73.9	69.9	193.7	23.6	38.1		9.0	16.5	34.9	38.6

The information presented on this sheet is correct at the time of publication. Hammond Valve reserves the right to change design, and/or material specifications without notice. For the Installation, Operation and Maintenance Manual (IOM) see the engineering section on our website. For the most current information access www.hammondvalve.com



HAMMONDVALVE