



# UP8614/8613 3/8"-3"



**Bronze Ball Valve For Potable Water**  
**Three Piece**  
**Full Port\***  
**600 psig WOG**  
**Solder Ends**

**Blow-Out Proof Stem**  
**Dimensions and Workmanship Conform to MSS SP-110**

## MATERIALS LIST

ITEM	PART	MODEL/SIZE	MATERIALS	ASTM SPEC.
1	Body	UP8614 & UP8613	Cast Bronze	B584 C89833
2	Tailpiece	UP8614 & UP8613	Cast Bronze	B584 C89833
3	Ball	UP8614	Brass w/Hard Chrome Plating	B283 C27450
		UP8613	316 Stainless Steel	A276 S31600
4	Stem	UP8614	Brass	B21 C46400, H02
		UP8613	316 Stainless Steel	A276 S31600
5	O-Ring	UP8614 & UP8613	Viton	Commercial
6	Seat	UP8614 & UP8613	15 % Glass RPTFE	Commercial
7	Thrust, Washer	UP8614 & UP8613	25% Glass RPTFE	Commercial
8	Packing Male	2- 1/2"-3"	PTFE	Commercial
	Packing	3/8"-2"	PTFE	Commercial
9	Packing, "V"	UP8614 & UP8613	PTFE	Commercial
10	Packing, Female	UP8614 & UP8613	PTFE	Commercial
11	Packing Follower	UP8614 & UP8613	Brass	B16 C36000
12	Hex Jam Nut	UP8614 & UP8613	Stainless Steel	Commercial
13	Nut Locker	UP8614 & UP8613	Stainless Steel TYP. 301/302	Commercial
14	Washer, Internal Tooth	UP8614 & UP8613	Stainless Steel	Commercial
15	Belleville, Washer	UP8614 & UP8613	Stainless Steel 17-7 PH	Commercial
16	Hex Head Cap Screw	UP8614 & UP8613	Steel	SAE, Grade 8
17	Socket Head Cap Screw	2-1/2"-3"	Carbon Steel	Commercial
18	Handle Assy	UP8614 & UP8613		
19	Gland Nut	3/8"-2"	Brass	B16 C36000
20	Hex Nut	3/8"-2"	Steel	SAE 5140

(1) Ball and stem are stainless for UP8613

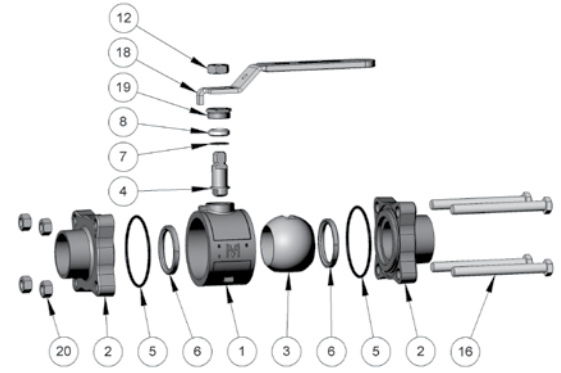

3/8" THRU 2"

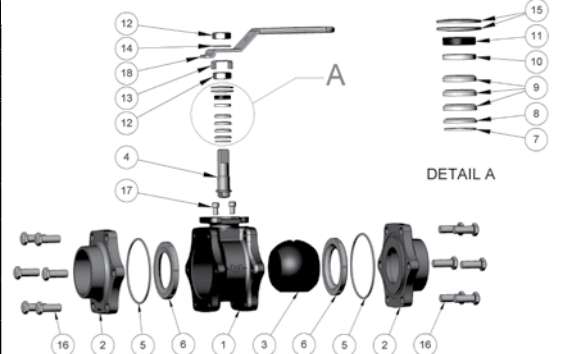

2-1/2" THRU 3"

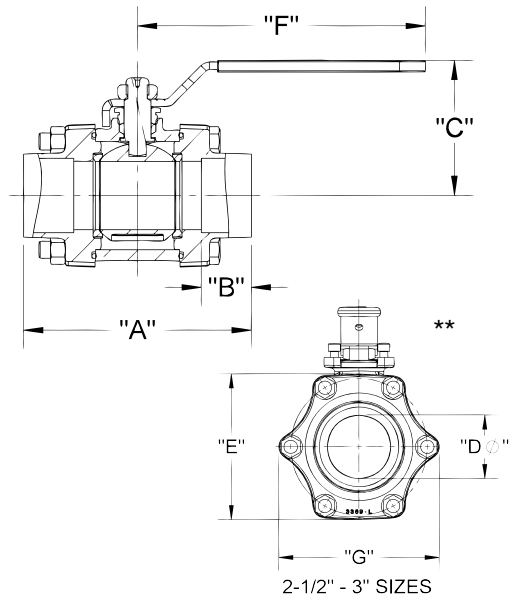

## DIMENSIONS

	UNITS	3/8"	1/2"	3/4"	1"	1-1/4"	1-1/2"	2"	2-1/2"	3"
		DN10	DN15	DN20	DN25	DN32	DN40	DN50	DN65	DN80
A	INCHES	2.68	3.02	3.56	3.81	4.66	5.00	5.70	7.01	7.01
	mm	68	77	90	97	118	127	145	178	178
B	INCHES	0.44	0.51	0.76	0.92	0.98	1.10	1.35	1.48	1.67
	mm	11	13	19	23	25	28	34	38	42
C	INCHES	1.85	1.85	2.20	2.65	2.79	2.97	3.47	5.44	5.44
	mm	47	47	56	67	71	75	88	138	138
D	INCHES	0.45	0.50	0.75	1.00	1.25	1.50	2.00	2.50	2.50
	mm	11	13	19	25	32	38	51	64	64
E	INCHES	1.32	1.32	2.13	2.41	2.94	3.13	3.86	5.74	5.74
	mm	34	34	54	61	75	80	98	146	146
F	INCHES	3.80	3.80	4.55	6.32	6.32	6.32	7.20	8.10	8.10
	mm	96	96	116	160	160	160	183	206	206
G	INCHES	1.92	1.92	2.13	2.41	2.94	3.13	3.86	6.31	6.31
	mm	49	49	54	61	75	80	98	160	160
Cv		7	17	31	60	110	185	360	390	390

\*3" is standard Port.

\*\*2-1/2" & 3" Only.

**Note:** Lead free refers to the wetted surface of the pipe, fittings and fixtures in potable water systems that have a weighted average lead content  $\leq 0.25\%$ . Source: California Health and Safety Code (116875).

The information presented on this sheet is correct at time of publication. Hammond Valve reserves the right to change design and/or materials without notice. For our Installation, Operation and Maintenance Manual and the most current product information go to [www.hammondvalve.com](http://www.hammondvalve.com). Hammond Valve is a registered trademark of Milwaukee Valve.

⚠ State of California Prop 65 **WARNING:** Cancer and Reproductive Harm. For more information visit [www.p65warnings.ca.gov](http://www.p65warnings.ca.gov).



# OPTIONS

## TIH THE INSULATOR/MS® Extension Handle

The **THE INSULATOR/MS®** extension handle is designed to prevent condensation and other extraneous moisture from entering the insulated piping system, while also minimizing thermal energy loss from the system via metal extension tubes, levers, and similar parts.



The design incorporates a unique memory stop feature that requires no disassembly or removal of the handle to engage and make adjustments.

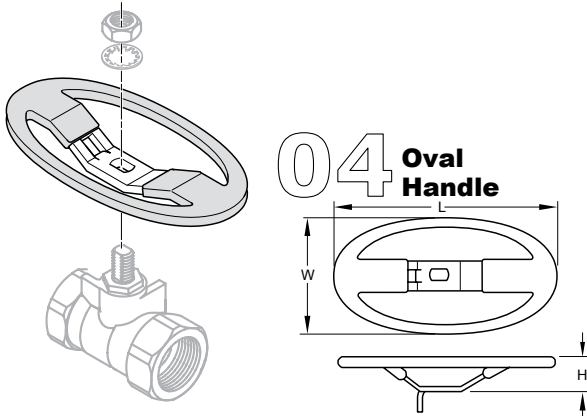

Oval handles can also prevent accidental valve operations, since they have less projection than a lever handle, and require more turning force to operate. OSHA requires the use of oval handles in many installations for safety reasons.

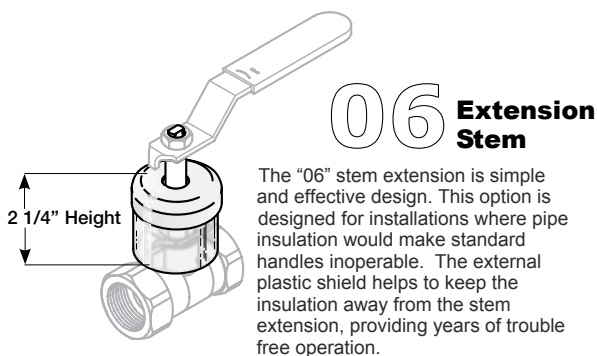

The "06" stem extension is simple and effective design. This option is designed for installations where pipe insulation would make standard handles inoperable. The external plastic shield helps to keep the insulation away from the stem extension, providing years of trouble free operation.

## 07 Locking Device

The "07" Locking Handle offers the end user the security of a pad lockable handle. The handle can be locked in either the full open position, or full closed by adding a standard padlock. The locking handle design will accommodate a standard 5/16" pad-lock or other types of valve lockouts. The handle and locking device are also manufactured of stainless steel material for additional strength and corrosion resistance.

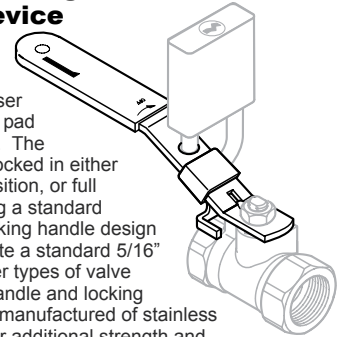

## 08 Stainless Steel Handle

The "08" handle option adds a 316 stainless steel handle and nut to a standard bronze ball valve. This option is intended for harsh environments like areas subject to salt water spray, high humidity, cleaning chemicals, etc.

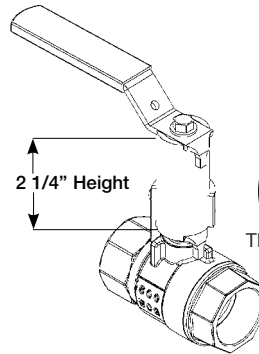
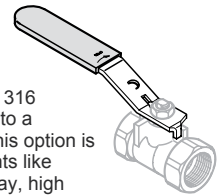

## 09 Extension Handle with Memory Stop

The "09" stem extension is all-metallic with an adjustable memory stop. This option is designed for installations where pipe insulation would make standard handles inoperable. The adjustable memory stop allows the valve opening to be limited to a preset position. This option can be ordered with or without the memory stop.

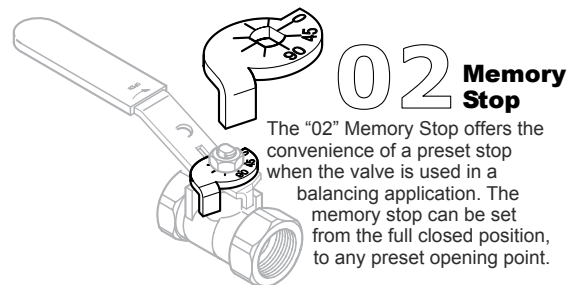

The "02" Memory Stop offers the convenience of a preset stop when the valve is used in a balancing application. The memory stop can be set from the full closed position, to any preset opening point.

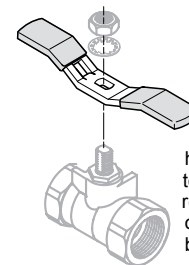

## 03 Tee Handle

Tee handles offer the same installation space savings as oval handles, with a slightly shorter end to end dimension. Tee handles require more handle force to operate, so accidental openings can be reduced.

The information presented on this sheet is correct at time of publication. Hammond Valve reserves the right to change design and/or materials without notice. For our Installation, Operation and Maintenance Manual and the most current product information go to [www.hammondvalve.com](http://www.hammondvalve.com). Hammond Valve is a registered trademark of Milwaukee Valve.

⚠ State of California Prop 65 **WARNING:** Cancer and Reproductive Harm. For more information visit [www.p65warnings.ca.gov](http://www.p65warnings.ca.gov).